



Stagehand Platform shown attached to a Trouper Staging Deck

Contents

Important User Information	2	Safety Precautions	3
General	2	Required Tools	3
Manufacturer	2	Supplied Hardware	3
Installation	2	Replacement Parts List	4
Warranty	2	Assembly	5
		Troubleshooting	8



For more information on Stagehand Staging, visit the Trouper Staging web page at wengercorp.com.

Note: Please read and understand these instructions before assembly or use.
Note: If you need additional information, contact Wenger Corporation using the information below.

Important User Information

General

Copyright © 2024 by Wenger Corporation

All rights reserved. No part of the contents of this manual may be reproduced, copied, or transmitted in any form or by any means including graphic, electronic, or mechanical methods or photocopying, recording, or information storage and retrieval systems without the written permission of the publisher, unless it is for the purchaser's personal use.

Printed and bound in the United States of America.

The information in this manual is subject to change without notice and does not represent a commitment on the part of Wenger Corporation. Wenger Corporation does not assume any responsibility for any errors that may appear in these instructions.

In no event will Wenger Corporation be liable for technical or editorial omissions made herein, nor for direct, indirect, special, incidental, or consequential damages resulting from the use or defect of these instructions. The manufacturer reserves the right to change this product at any time.

The information in this document is not intended to cover all possible conditions and situations that might occur. The end user must exercise caution and common sense when assembling or installing Wenger Corporation products. If any questions or problems arise, call the Wenger Corporation at (800) 4WENGER (493-6437) or +1-507-455-4100 worldwide.

Manufacturer

The Stagehand® Platform is manufactured by:

Wenger Corporation
555 Park Drive
Owatonna, MN 55060
(800) 4WENGER (493-6437) • +1 (507) 455-4100
wengercorp.com

Intended Use

- This product is intended for indoor use in normal ambient temperature and humidity conditions – it must not be exposed to prolonged outside weather conditions.
- This product is intended to be assembled only as described in these instructions.

Warranty

Warranty information is available at wengercorp.com.

Safety Precautions

Throughout this document you may find cautions and warnings which are defined as follows:

- **WARNING:** Failure to follow the instruction could result in serious injury or damage to property.
- **CAUTION:** Failure to follow the instruction could result in minor injury or damage to property.

Read all of these safety instructions before assembly or use.

CAUTION

Make sure anyone assembling or using this product has read and understands these instructions.

CAUTION

Failure to comply with Warnings and Cautions in this document or on the equipment can result in damage to property or injury.

Required Tools

- Ratchet wrench, with 7/16" and 3/4" sockets
- 7/16" and 3/4" wrenches
- Power driver with phillips head bit

Supplied Hardware

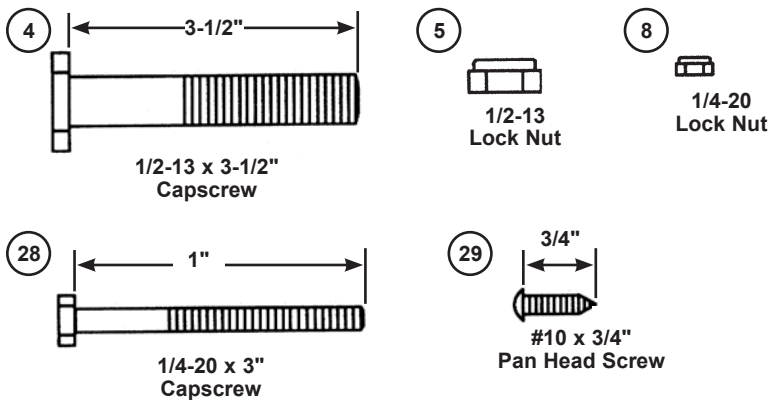

Replacement Parts List

Item	Qty	Description	Item	Qty	Description	Item	Qty	Description
1	1	Cart weldment	11	2	Clevis, gas spring	21	2	Pad, rubber, saddle
2	2	Arm, swing	12	2	Plate, pivot, gas spring	22	-	-
3	4	Spacer, short	13	4	Nut, hex, M10 x 1	23	6	Plug, plastic, 1" x 1-1/2"
4	2	Capscrew, 1/2-13 x 3-1/2"	14	2	Cam, pedal bar	24	2	Bushing, nylon
5	2	Nut, lock, 1/2-13	15	1	Tube, pedal	25	2	Capscrew, 5/16-18 x 3-1/2"
6	1	Cross tube weldment	16	2	Spring, torsion	26	4	Nut, lock, 5/16-18
7	4	Capscrew, 1/4-20 x 3/4"	17	1	Sleeve, foam	27	2	Bracket, channel
8	6	Nut, lock, 1/4-20	18	2	Capscrew, 1/4-20 x 1-3/4"	28	2	Capscrew, 1/4-20 x 3"
9	2	Caster, swivel, 4" dia	19	2	Capscrew, 5/16-18 x 3-3/4"	29	16	Screw, pan, #10 x 3/4"
10	2	Spring, gas, locking	20	2	U-channel, extruded rubber	30	2	Caster, braked, 4" dia

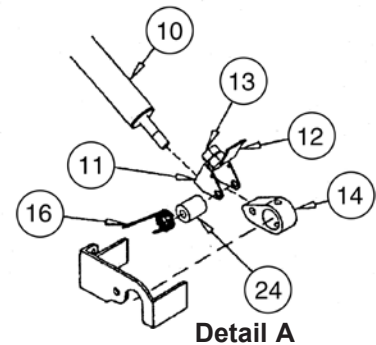
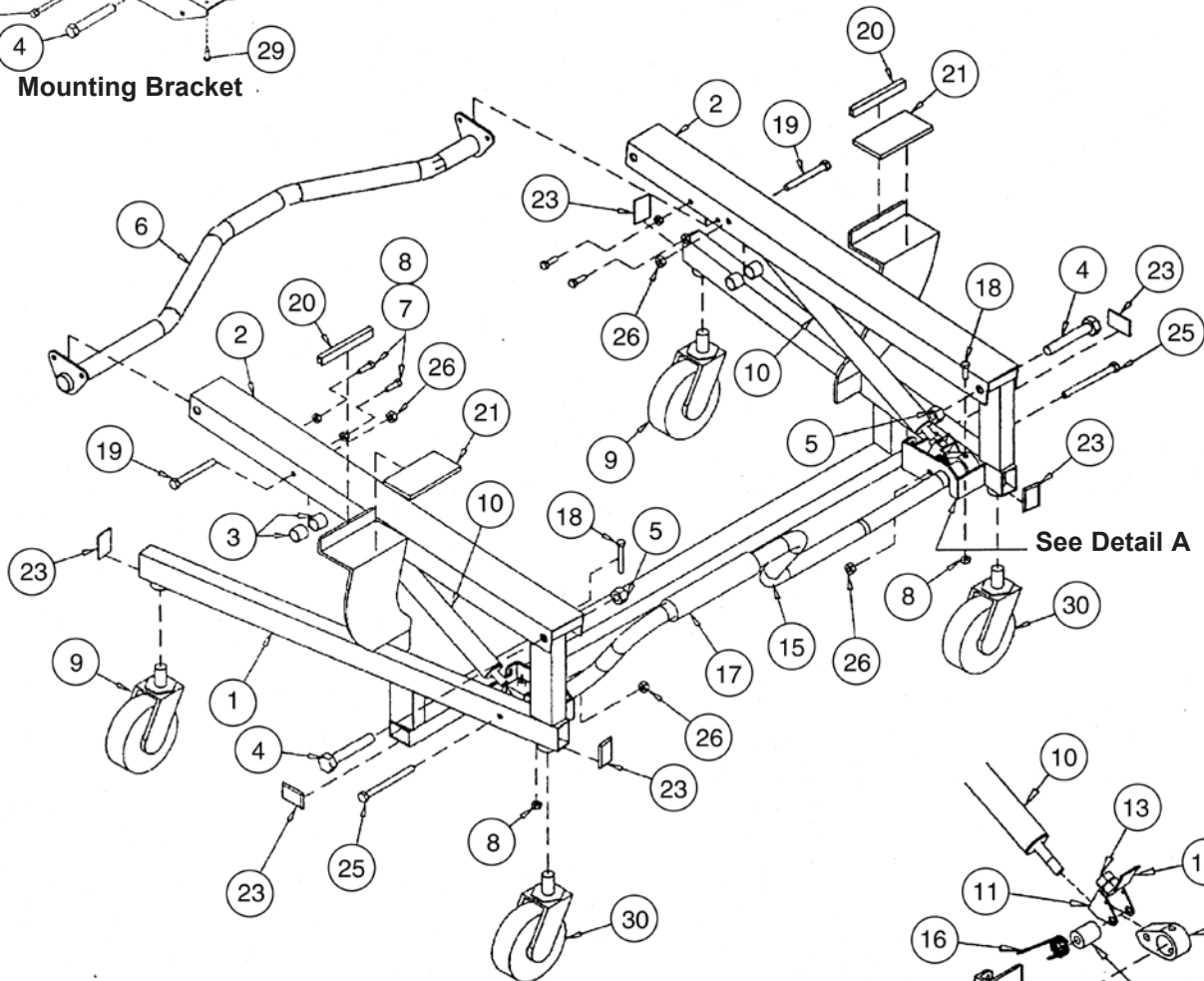
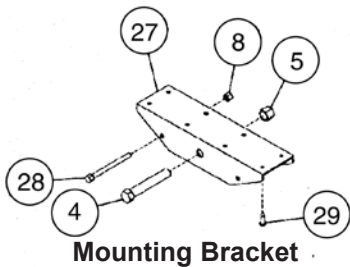

Assembly

1. Lay the deck section face-down, and unfold the legs.
2. There are four pilot holes on the bottom side of the deck to locate the bracket mounting locations. Using the template provided, mark sixteen screw locations for attaching the mounting brackets (27).
3. Attach the two cart-mounting brackets (27) with the sixteen provided #10 x 3/4" pan head screws (29).
4. Set the deck section on edge — with the legs and braces oriented as shown.

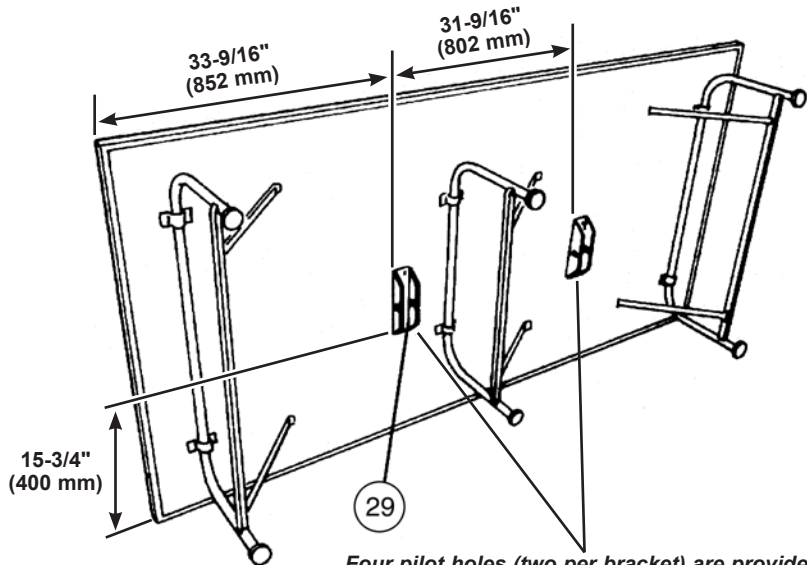

Four pilot holes (two per bracket) are provided to locate bracket positions.

The brackets are off-center. When the deck section is set on edge, be sure the brackets are closer to the bottom edge of the deck.

5. Disconnect one end of the cart cross tube (6) from the swing arm (2) — two screws.
6. Roll the cart close to the deck.
 - a. Maneuver the cross tube between the folding braces of the deck's center leg.
 - b. Reattach the cross tube loosely to the swing arm, with the same two screws.

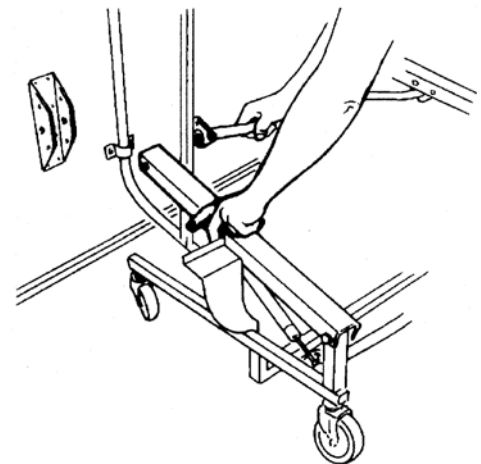

Assembly (continued)

- Attach the swing arms to the center hole of the two mounting brackets on the deck.

Tighten the nuts just until snug, to avoid binding.

CAUTION

Two people are required – one to lift the outer side of the cart (the pedal side), the other to fasten the arms.

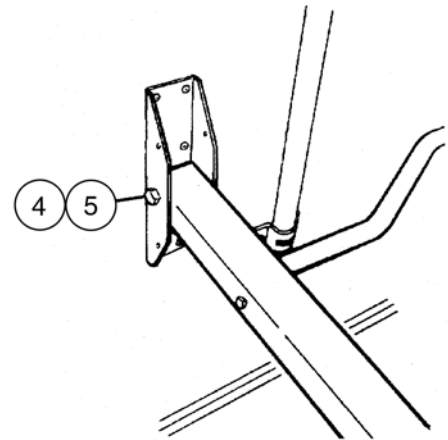

Reattach cross tube and arms as shown

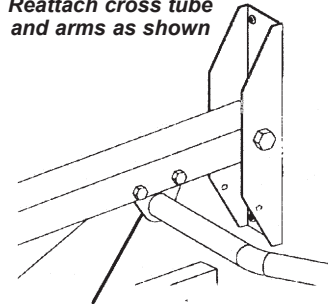

Bolt the plate to the inside of the arm

- Install a stop bolt in the bottom hole of both mounting brackets. Tighten the nuts just until snug, to avoid binding.

This bolt serves as a stop for the swing arms

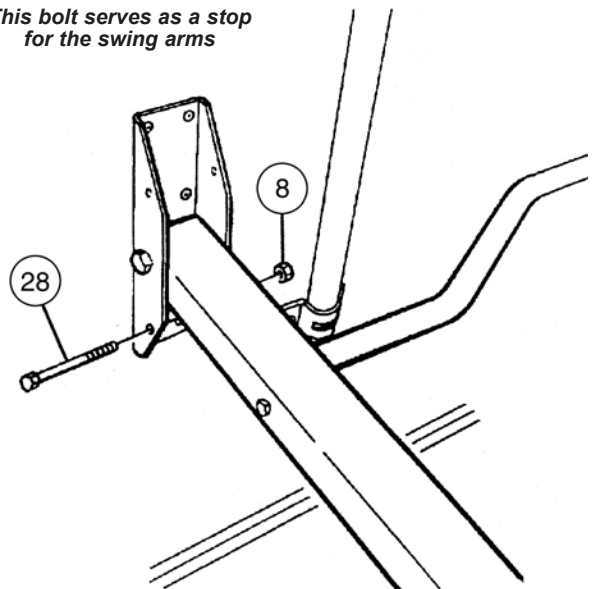

Assembly (continued)

9. Depress the pedal, and allow the deck to settle down to the floor.
10. Lift the deck to its upper position.
Be sure the deck is sitting in both saddles, then release the pedal.
11. Tighten the four nuts that attach the cross tube to the swing arms.
12. To fold and unfold the platform, see the Operating Instructions decal.

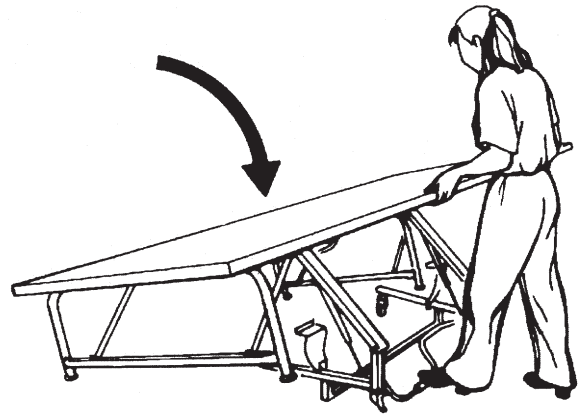

The deck will be wobbly until the nuts are tightened in step 11

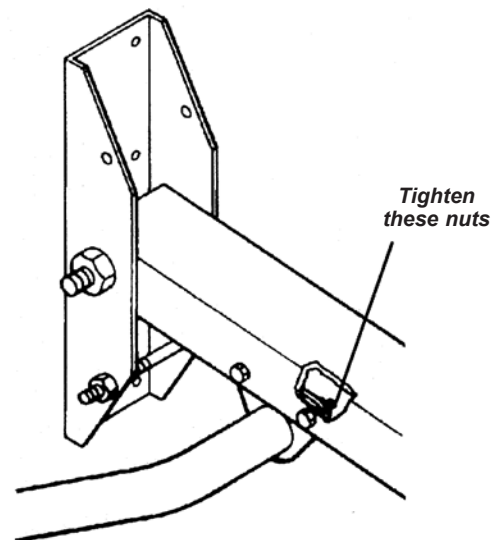
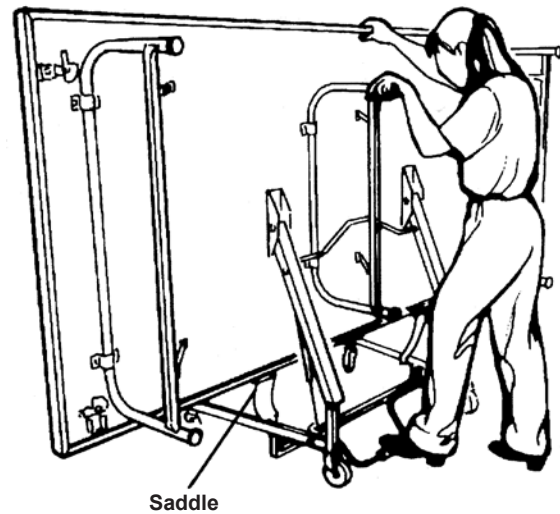

Troubleshooting

"I put it together and the deck:"

- deck does not rotate freely.
- deck does not raise evenly into the storage position.
- deck does not sit evenly in the storage saddles.
- legs do not all touch the floor when down.

Review the notes and comments on this page for some hints and items to check.
Step numbers noted refer to the steps in the assembly instructions on the previous pages.

Some Operating Tips:

- Use your left foot for depressing the foot pedal.
- Grab the center leg with your left hand as you are lifting the deck into the storage position. Tip the deck to vertical while lifting.
- Do not try to overpower the deck while lifting it into the storage position. Let the gas springs help!
- Check floor for flatness and shim if necessary.
- Note the deck orientation (step 3). Do not attach the deck upside down! Note the orientation of the legs and leg braces in the diagram.

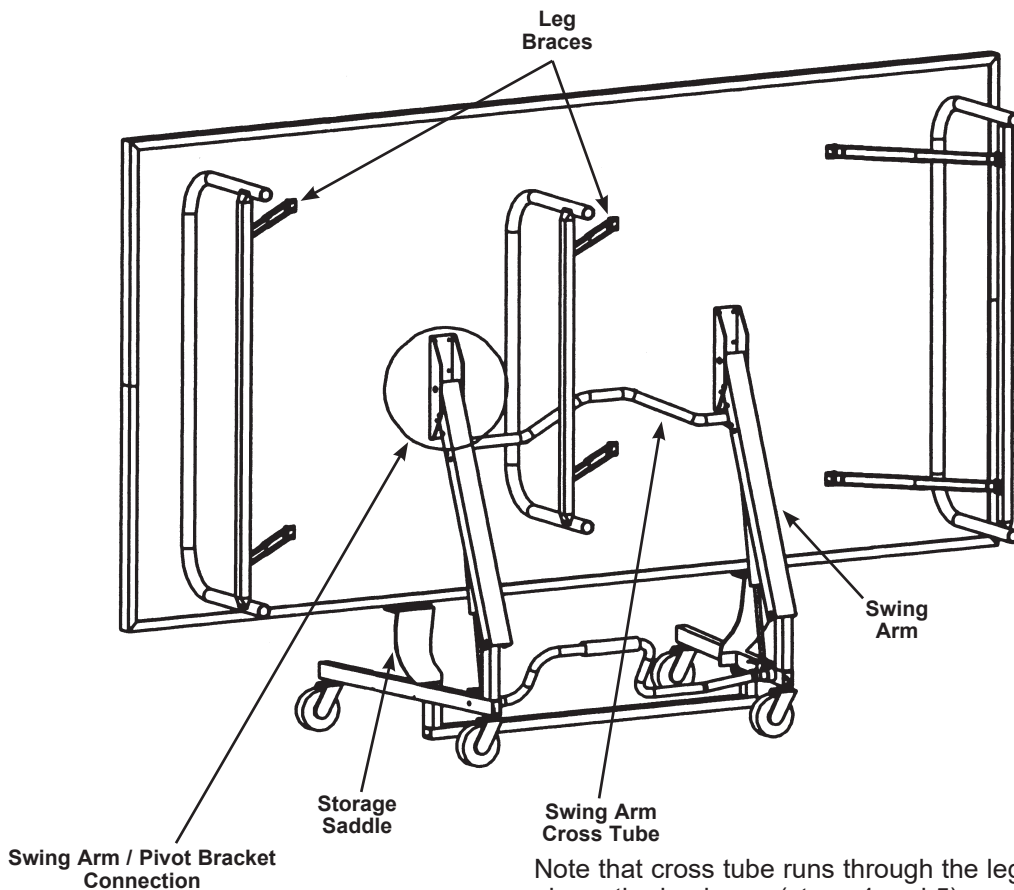

Swing Arm / Pivot Bracket Connection

Over-tightening of pivot bolts (step 6) and/or stop bolts (step 7) will prevent the deck from rotating freely.

Note that cross tube runs through the leg assembly and above the leg brace (steps 4 and 5).

Leave all four cross tube attachment bolts loose until deck is lifted and set into storage saddles (step 5). Tightening the bolts in this position (step 10) squares up the swing arms.

The plates on the ends of the cross tube go to the inside of the swing arm channels (see diagram in step 10).